

Macho rosca cónica BSPT

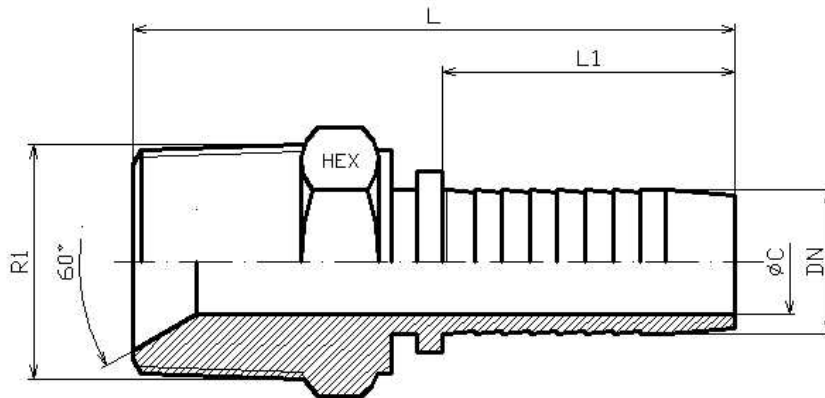

Artículo	DN	R1	L	L1	HEX 1	ØC
241140203	3/16"	1/8" BSPT	44,5	28	14	3
241140204	1/4"	1/8" BSPT	49	28	14	4
241140404	1/4"	1/4" BSPT	53,5	28	14	4
241140604	1/4"	3/8" BSPT	55	28	19	4
241140605	5/16"	3/8" BSPT	55	28	19	5,5
241140606	3/8"	3/8" BSPT	57	29,5	19	7
241140806	3/8"	1/2" BSP	62	29,5	22	7
241140808	1/2"	1/2" BSP	62,5	30,5	22	9,5
241141210	5/8"	3/4" BSPT	70,3	34	30	12
241141212	3/4"	3/4" BSPT	78	39	30	15
241141612	3/4"	1" BSPT	81	39	36	15
241141616	1"	1" BSPT	89	47	36	19
241142016	1"	1"1/4 BSPT	96	47	46	19
241142020	1" 1/4	1"1/4 BSPT	105	54,5	46	26
241142424	1" 1/2	1" 1/2 BSPT	104	58	50	32
241143232	2"	2" BSPT	125	72	65	44