

Hembras giratorias rectas JIC 37°

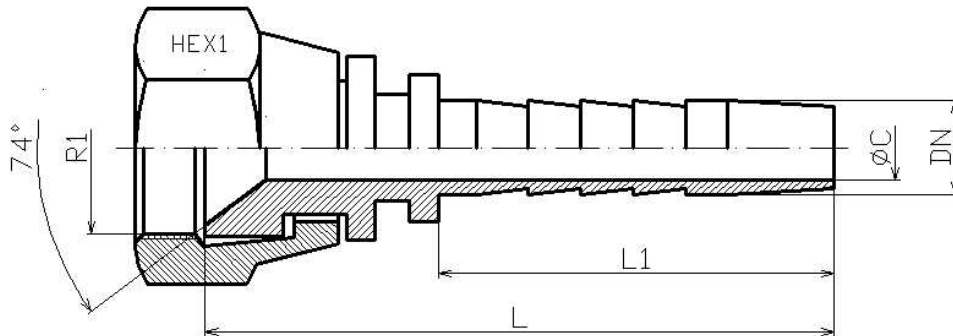

Artículo	DN	R1	L	L1	HEX 1	ØC
241420703	3/16"	7/16" 20h UNF	38,5	24	14	3
241420704	1/4"	7/16" 20h UNF	43	28	14	4
241420804	1/4"	1/2" 20h UNF	44	28	17	4
241420805	5/16"	1/2" 20h UNF	44,5	28	19	5,5
241420904	1/4"	9/16" 18h UNF	45	28	19	4
241420905	5/16"	9/16" 18h UNF	45	28	19	5,5
241420906	3/8"	9/16" 18h UNF	46,5	29,5	19	7
241421006	3/8"	5/8" 18h UNF	48	34,5	22	7
241421205	5/16"	3/4" 16h UNF	47	28	24	5,5
241421206	3/8"	3/4" 16h UNF	48,5	29,5	24	7
241421208	1/2"	3/4" 16h UNF	49	30,5	24	9,5
241421406	3/8"	7/8" 14h UNF	49,5	29,5	27	7
241421408	1/2"	7/8" 14h UNF	50	30,5	27	9,5
241421410	5/8"	7/8" 14h UNF	54,5	34	27	12
241421708	1/2"	1"1/16 12h UNF	51	30,5	32	9,5
241421710	5/8"	1"1/16 12h UNF	55,8	34	32	12
241421712	3/4"	1"1/16 12h UNF	62	39	32	15
241421716	1"	1"1/16 12h UNF	70	47	32	19
241422112	3/4"	1"5/16 12h UNF	63,5	39	41	15
241422116	1"	1"5/16 12h UNF	71,5	47	41	19
241422616	1"	1"5/8 12h UNF	74	47	50	19
241422620	1"1/4"	1"5/8 12h UNF	83	54,5	50	26

Hembras giratorias rectas JIC 37°

Artículo	DN	R1	L	L1	HEX 1	ØC
241423020	1"1/4	1"7/8 12h UNF	84,5	54,5	55	26
241423024	1"1/2	1"7/8 12h UNF	88	58	55	32
241424032	2"	2"1/2 12h UNF	102	72	70	44