

## Hembras giratorias rectas BSP cono 60°

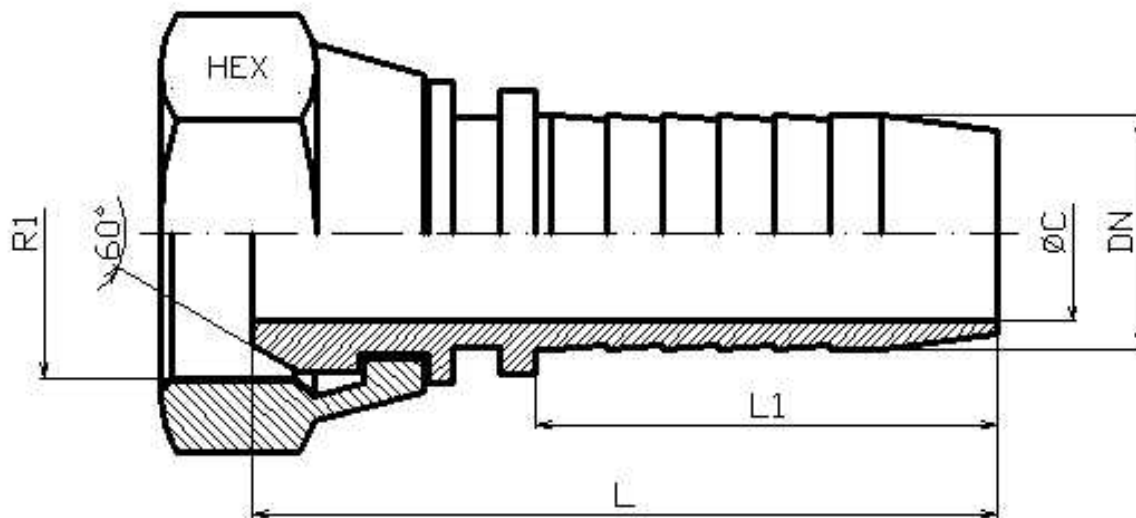

Artículo	DN	R1	L	L1	HEX 1	ØC
241000202	1/8"	1/8" BSP	36	22	13	2
241000203	3/16"	1/8" BSP	38,5	24	14	3
241000204	1/4"	1/8" BSP	43	28	14	4
241000403	3/16"	1/4" BSP	39,5	24	19	3
241000404	1/4"	1/4" BSP	44	28	19	4
241000405	5/16"	1/4" BSP	44,5	28	19	5,5
241000406	3/8"	1/4" BSP	45,5	29,5	19	7
241000604	1/4"	3/8" BSP	45,5	28	22	4
241000605	5/16"	3/8" BSP	46	28	22	5,5
241000606	3/8"	3/8" BSP	47,5	29,5	22	7
241000608	1/2"	3/8" BSP	48	30,5	22	9,5
241000804	1/4"	1/2" BSP	46,5	28	27	4
241000806	3/8"	1/2" BSP	48,5	29,5	27	7
241000808	1/2"	1/2" BSP	48,5	30,5	27	9,5
241000810	5/8"	1/2" BSP	53,3	34	27	12
241001008	1/2"	5/8" BSP	50	30,5	30	9,5
241001010	5/8"	5/8" BSP	54,8	34	30	12
241001208	1/2"	3/4" BSP	52	30,5	32	9,5
241001210	5/8"	3/4" BSP	56,8	34	32	12
241001212	3/4"	3/4" BSP	63	39	32	15
241001612	3/4"	1" BSP	66,5	39	41	15
241001616	1"	1" BSP	74,5	47	41	19