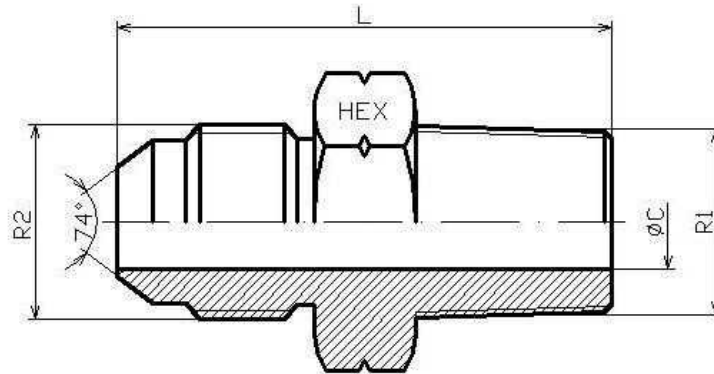

Straight adaptor male JIC-male NPT

Part nº	ØD1	ØD2	R1	R2	L	HEX 1	ØC
S2000610	6	1/4	1/8" NPT	7/16" 20h UNF	30,5	14	4,4
S2000613	6	1/4	1/4" NPT	7/16" 20h UNF	3,5	17	4,4
S2000810	8	5/16	1/8" NPT	1/2" 20h UNF	30,5	17	6
S2000813	8	5/16	1/4" NPT	1/2" 20h UNF	33,5	17	6
S2001013	10	3/8	1/4" NPT	9/16" 18h UNF	33,6	17	7,5
S2001017	10	3/8	3/8" NPT	9/16" 18h UNF	35,1	19	7,5
S2001021	10	3/8	1/2" NPT	9/16" 18h UNF			
S2001217	12	1/2	3/8" NPT	3/4" 16h UNF	39,7	22	9,9
S2001221	12	1/2	1/2" NPT	3/4" 16h UNF	41,2	22	9,9
S2001226	12	1/2	3/4" NPT	3/4" 16h UNF	44,7	27	9,9
S2001621	14-15-16	5/8	1/2" NPT	7/8" 14h UNF	43,8	24	12,3
S2001626	14-15-16	5/8	3/4" NPT	7/8" 14h UNF	47,3	27	12,3
S2002021	18-20	3/4	1/2" NPT	1"1/16 12h UNF	48,6	27	15,5
S2002026	18-20	3/4	3/4" NPT	1"1/16 12h UNF	52,9	27	15,5
S2002033	18-20	3/4	1" NPT	1"1/16 12h UNF	57,9	36	15,5
S2002526	25	1	3/4" NPT	1"5/16 12h UNF	54,1	36	21,5
S2002533	25	1	1" NPT	1"5/16 12h UNF	59,1	36	21,5
S2003233	32	1 1/4	1" NPT	1"5/8 12h UNF	62,3	46	27
S2003242	32	1 1/4	1"1/4 NPT	1"5/8 12h UNF	62,3	46	27,5
S2003842	38	1 1/2	1"1/4 NPT	1"7/8 12h UNF	67,3	55	33
S2003848	38	1 1/2	1"1/2 NPT	1"7/8 12h UNF	67,3	55	33