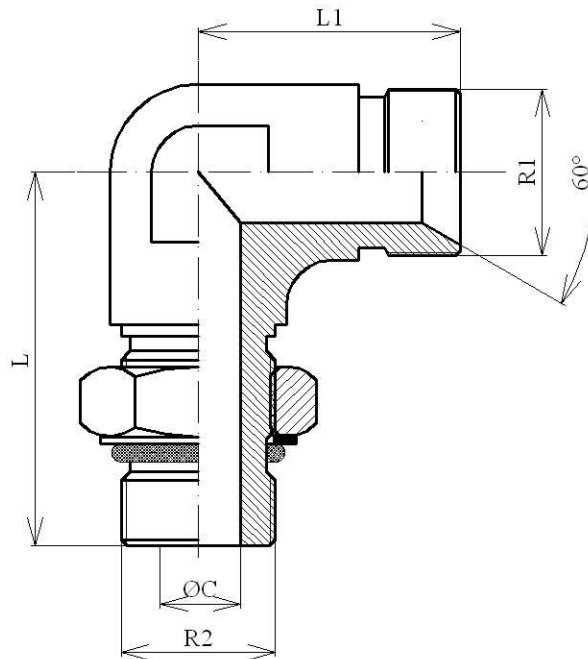

90° Elbow BSP male-BSP male adjustable forge

Part n°	R1	R2	L	L1	ØC
S11970404	1/4" BSP	1/4" BSP	27,6	25,4	4,7
S11970604	3/8" BSP	1/4" BSP			
S11970606	3/8" BSP	3/8" BSP	32,9	28,5	7,9
S11970806	1/2" BSP	3/8" BSP			
S11970808	1/2" BSP	1/2" BSP	42	32,5	11,1
S11971208	3/4" BSP	1/2" BSP			
S11971212	3/4" BSP	3/4" BSP	51,3	41,3	16,7
S11971612	1" BSP	3/4" BSP			
S11971616	1" BSP	1" BSP	54,2	44,5	22,2
S11972020	1"1/4 BSP	1"1/4 BSP	62,9	50,8	28,6